

# THERMOSTATIC RAINFALL WATERFALL PHONE CONTROLLED SHOWER SYSTEM WITH SOUND SYSTEM AND HANDHELD SHOWER SPECIFICATIONS

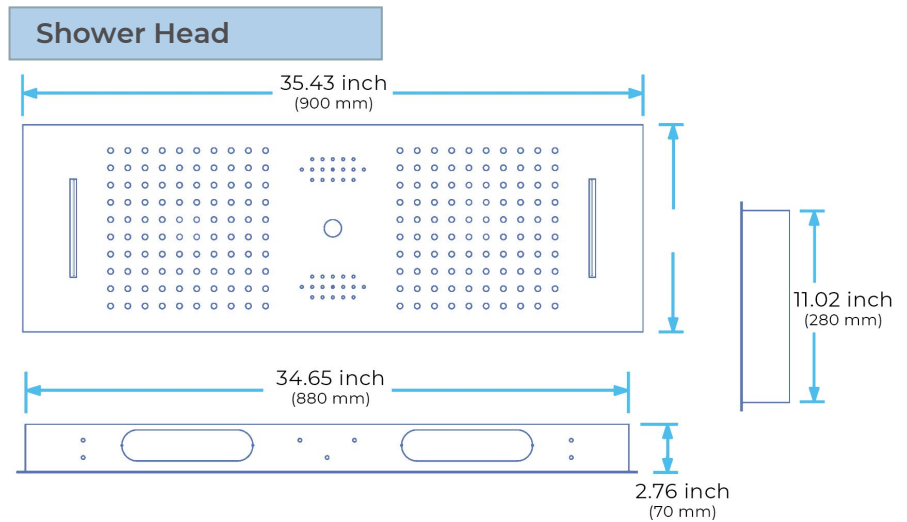

- Shower Panel /Hose Material: 304 Stainless Steel
- Shower Head Size: 900\*300 mm
- Shower Mixer Material: Brass
- Concealed Mixer Size: 465\*130 mm
- Showerheads Install: Embedded Ceiling Mounted
- Concealed Mixer Install: Wall-Mounted
- LED Shower Head Functions: Rainfall, Waterfall, Water Column
- Water Pressure: 0.3 MPA
- Water Flow: 16L/min~28L/min
- Hand Shower/ Shower holder Material: Brass
- Shower Accessories Material: Brass
- LED Light: Need to Connect Power
- LED Light Color: 64 Color
- Shower Hose Length: 1.5M
- AC: 100-265V 50/60Hz

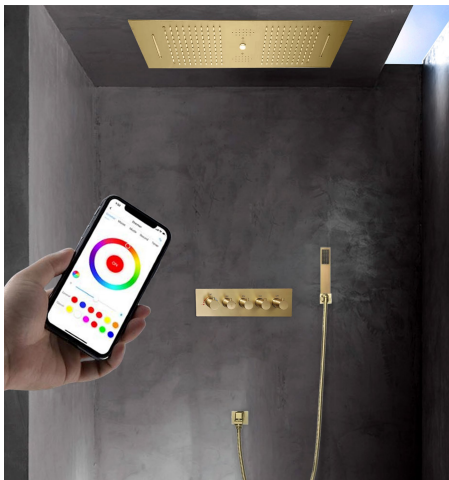
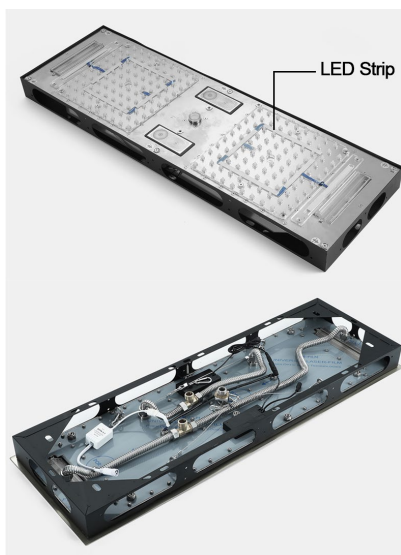
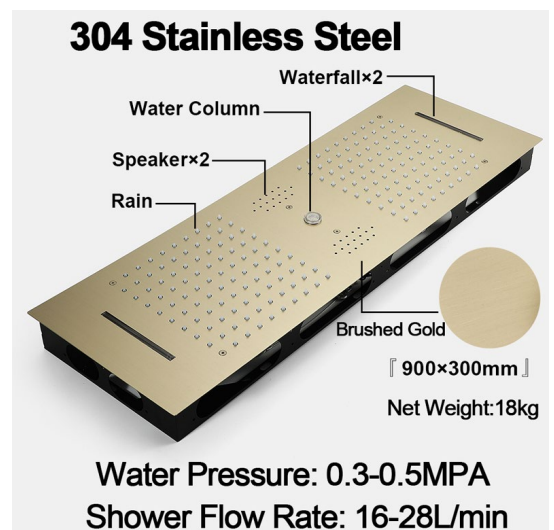

Kinds of color **64**  
temperature adjustable

**WiFi**

**Build-in WIFI**

**Phone control color**

**Color software App install instruction**  
**download name: Smart Life**

All dimensions and specifications are nominal and may vary. Use actual products for accuracy in critical situations.

**Shower Mixer**

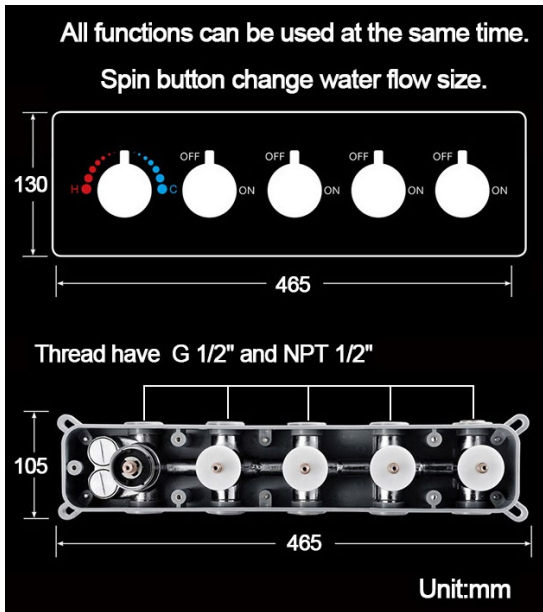

**Spout**

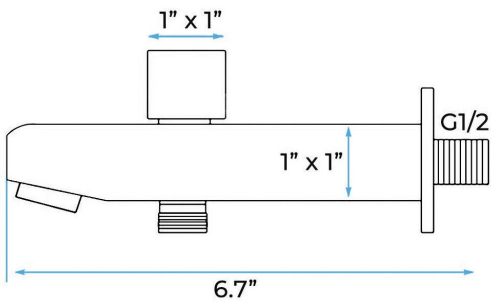

**Hand Shower**

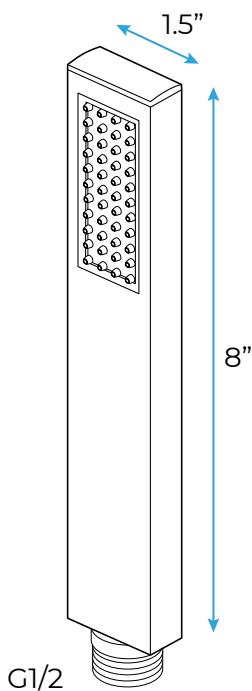

Flow Rate: 2.0 GPM / 7.6 LPM



**38°C**

Thermostatic Control

Main body  
Brass casting body

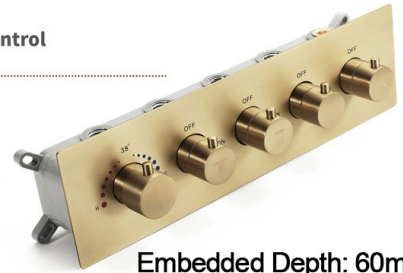

Embedded Depth: 60mm

Brushed gold



**Shower Mixer Connections**

